

W1G200-HH01-52

EC axial compact fan

sickled blades (S series)

ASIA PACIFIC SHENGRUI LIMITED

Phone +00852 56261528

info@apacfan.com

www.apacfan.com

Nominal data

Type	W1G200-HH01-52	
Motor	M1G074-BF	
Nominal voltage	VDC	48
Nominal voltage range	VDC	36 .. 57
Frequency	Hz	-
Type of data definition		rfa
Speed	min ⁻¹	2950
Power input	W	55
Current draw	A	1.3
Max. back pressure	Pa	120
Min. ambient temperature	°C	- 25
Max. ambient temperature	°C	+60

ml = max. load · me = max. efficiency · rfa = running at free air · cs = customer specs · cu = customer unit
Subject to alterations

Technical features

Leakage current	<= 0.25 mA
Size	200 mm
Operation mode	S1
Direction of rotation	Counter-clockwise, seen on rotor
Mounting position	Any
Electrical leads	Via terminal strip
EMC interference emission	Acc. to EN 55022 (Class B)
EMC interference immunity	Acc. to EN 61000-6-2 (industrial environment)
Humidity class	F0
Direction of air flow	"V"
Insulation class	"B"
Condensate discharge holes	None
Motor bearing	Ball bearing
Mass	2.15 kg
Material of blades	Sheet steel, coated in black
Material of wall ring	Die-cast aluminium
Motor protection	Reverse polarity and locked-rotor protection
Product conforming to standard	EN 60335-1
Surface of rotor	Coated in black
Number of blades	9
Type of protection	IP 42
Protection class	I
Technical features	<ul style="list-style-type: none"> - Control input 0-10 VDC / PWM - Line undervoltage detection - Motor current limit - Soft start
Max. permissible ambient motor temp. (transp./ storage)	+ 80 °C
Min. permissible ambient motor temp. (transp./storage)	- 40 °C
Approval	CCC; CSA C22.2 Nr.77; UL 1004-1

W1G200-HH01-52

EC axial compact fan

sickled blades (S series)

Product drawing

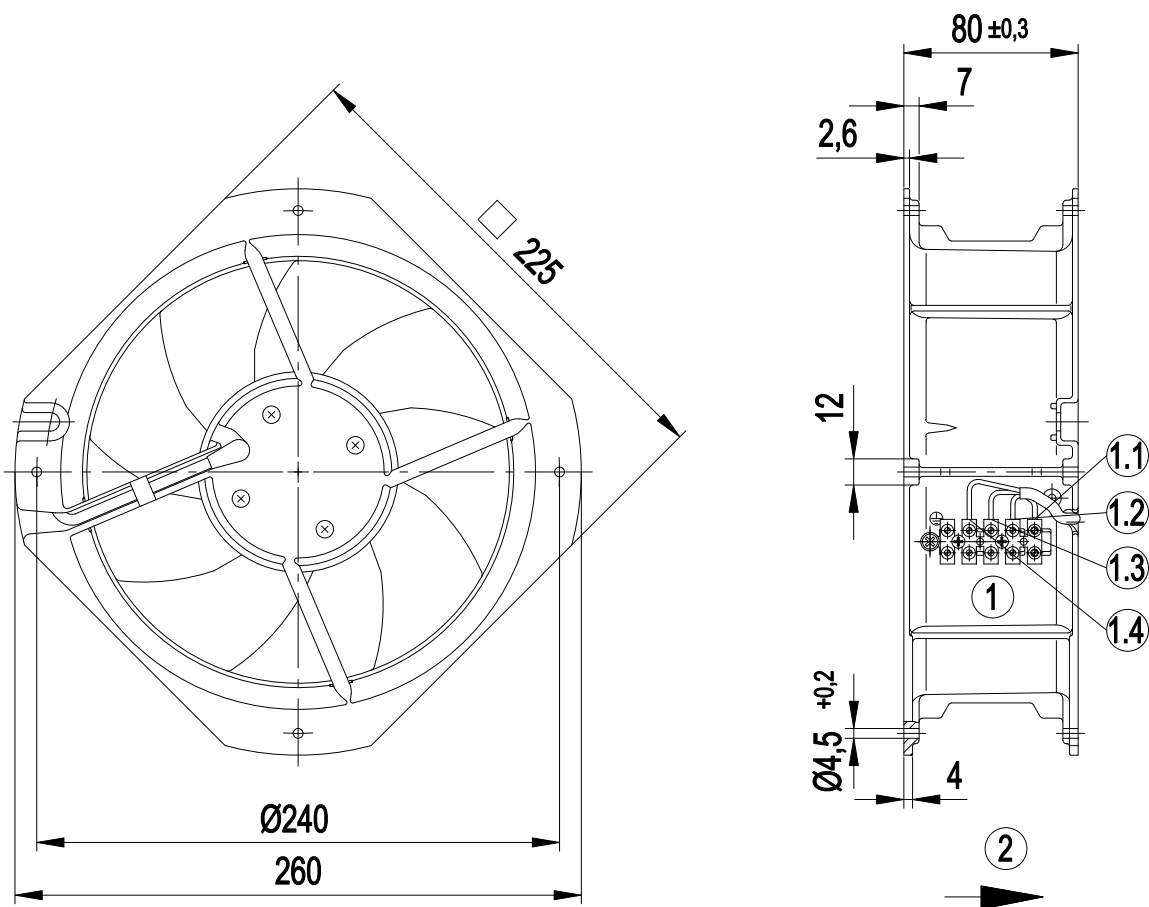

1	Connection: terminal strip with 5 terminals.
1.1	UN +48 VDC (red)
1.2	GND (blue)
1.3	DUE (white)
1.4	0-10 VDC (yellow)
2	Direction of air flow "V"

Connection screen

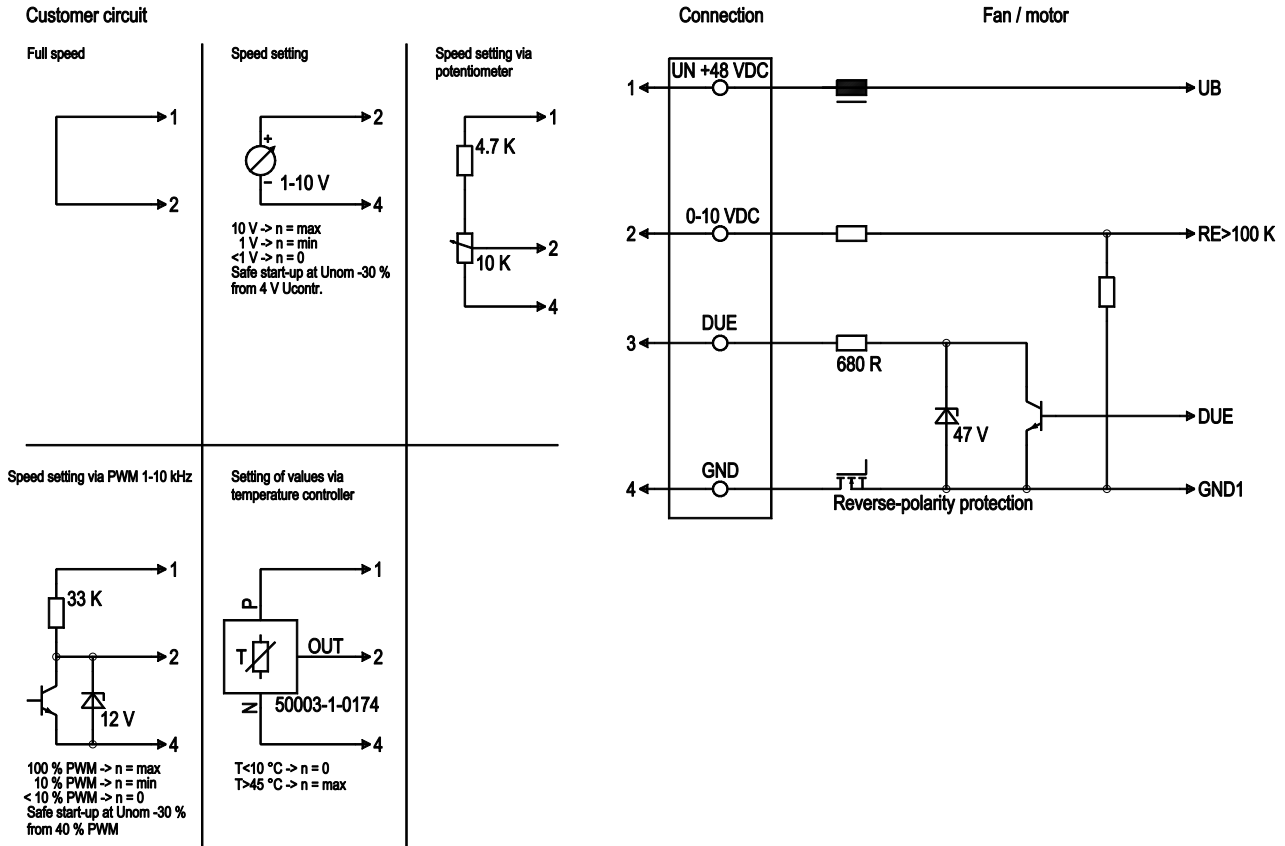

Line	No.	Signal	Colour	Function / assignment
1	1	Un +48 VDC	red	Power supply 48 VDC, residual ripple 3.5 %
1	2	0-10 VDC	yellow	Control input Re > 100 K
1	3	DUE	white	Speed monitoring output, 3 pulses per rotation, Isink max = 10 mA
1	4	GND	blue	Reference mass

Charts: Air flow

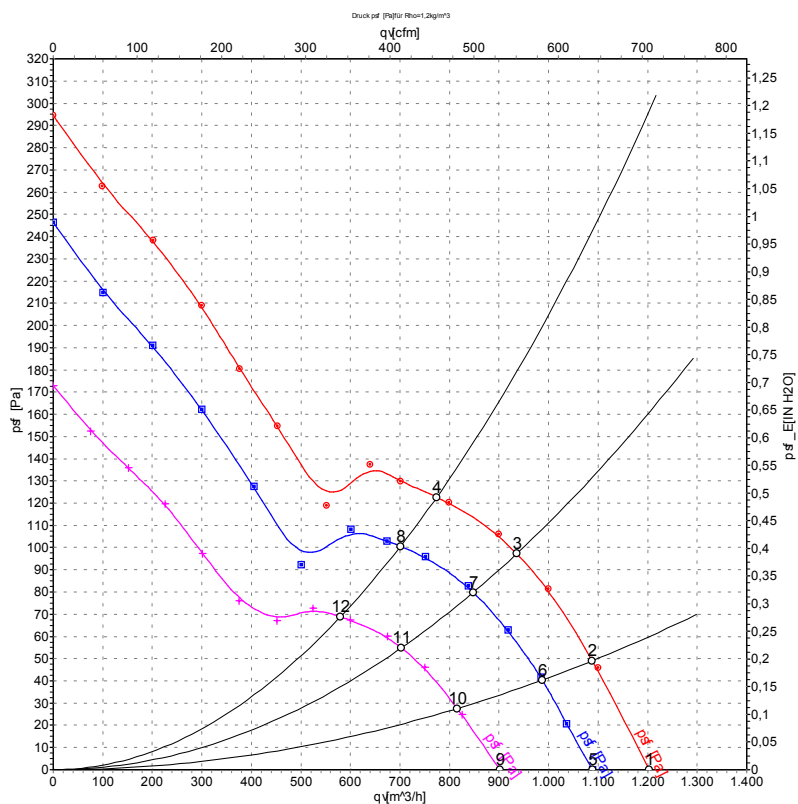

Measurement: LU-122619
 Measurement: LU-122613
 Measurement: LU-122617

Air performance measured as per ISO 5801 Installation Category A. For detailed information on the measuring set-up, please contact ebm-papst. Suction-side noise levels: L_{wA} measured as per ISO 13347 / L_{pA} measured with 1m distance to fan axis. The values given are valid under the measuring conditions mentioned above and may vary according to the actual installation situation. With any deviation from the standard set-up, the specific values have to be checked and reviewed with the unit installed.

Measured values

	U	n	P ₁	I	qv	p _{sf}
	V	min ⁻¹	W	A	m ³ /h	Pa
1	57	3320	72	1.42	1205	0
2	57	3225	76	1.49	1090	50
3	57	3130	80	1.57	935	97
4	57	3070	83	1.62	775	123
5	48	2950	55	1.30	1090	0
6	48	2880	56	1.31	985	40
7	48	2810	59	1.38	850	80
8	48	2755	61	1.42	700	100
9	36	2500	34	1.11	900	0
10	36	2420	35	1.14	815	28
11	36	2360	36	1.16	705	55
12	36	2310	37	1.18	580	69